

## PN16 Y-STRAINER

### TECHNICAL REQUIREMENT :

- Face to Face dimensions Conform to EN558-1 list 1
- Flange dimensions Conform to EN1092-2 PN16
- Testing Conform to EN12266-1

NOTE: 1.DN50~DN300 meshes  $\Phi 1.5$   
 DN350~DN600 meshes  $\Phi 3.0$   
 2.It can be manufactured according to customer's requirement  
 3.DN450~DN600 Body and bonnet's materials are EN-GJS-450-10



Fig No. :STR801-PN16

### MATERIALS OF PARTS

NO.	PART NAME	MATERIAL
1	BODY	ASTM A536 65-45-12
2	SCREEN	SS304
3	BONNET	ASTM A536 65-45-12
4	PLUG	MALLEABLE CAST IRON
5	BONNET GASKET	GRAPHITE +08F

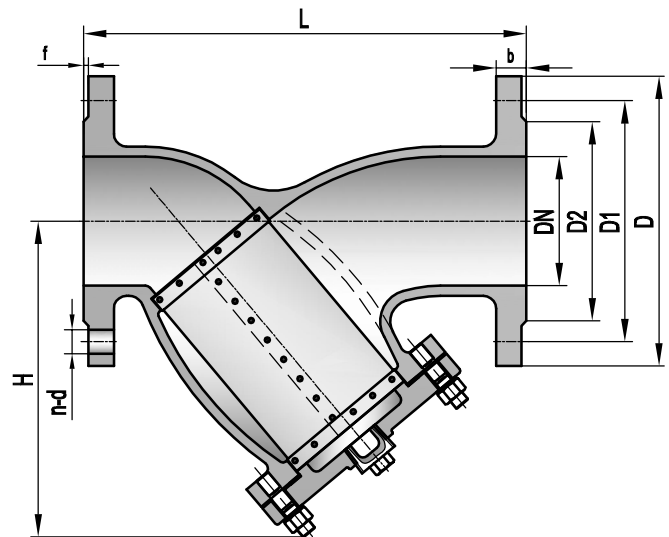

### DIMENSIONS DATA (MM)

DN	50	65	80	100	125	150	200	250	300	350	400	450	500	600
L	230	290	310	350	400	480	600	730	850	980	1100	1200	1250	1450
D	165	185	200	220	250	285	340	405	460	520	580	640	715	840
D1	125	145	160	180	210	240	295	355	410	470	525	585	650	770
D2	99	118	132	156	184	211	266	319	370	429	480	548	609	720
b	20	20	22	24	26	26	30	32	32	36	38	30	31.5	36
n-d	4-19	4-19	8-19	8-19	8-19	8-23	12-23	12-28	12-28	16-28	16-31	20-31	20-34	20-37
f	3	3	3	3	3	3	3	3	4	4	4	4	4	5
H	152	186.5	203	250	288	325	405	496	574	660	727	826.5	884	1022